

ALUMINIUM SKIRTING BAND

Use: for finishing a Grad deck

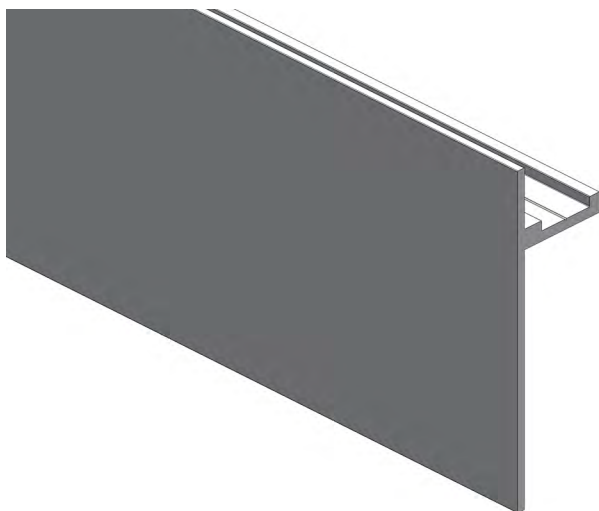

TECHNICAL CHARACTERISTICS

Material	Aluminium EN AW-6060
Skirting band weight (h = 100 mm)	3.76 kg
Skirting band weight (h = 150 mm)	5.06 kg
Colours	RAL 7016 - grey anthracite, textured Raw aluminium
Thermal treatment	T6
Tensile strength (MPa)	190
Elastic limit (MPa)	150
Minimum elongation (%)	6
Modus of elasticity (MPa)	70000
Coefficient of linear expansion (10 ⁻⁶ /K)	24
Melting temperature °C	585-655
Thermal transmittance (W/mK)	160
Paint quality	Qualicoat

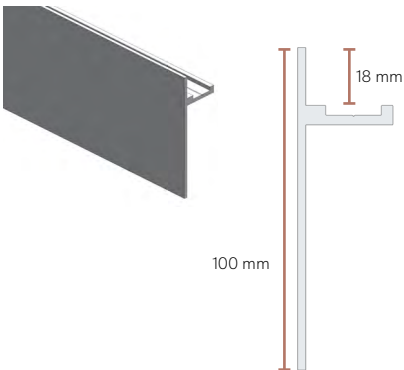
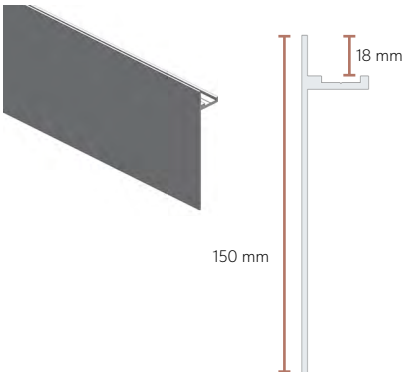
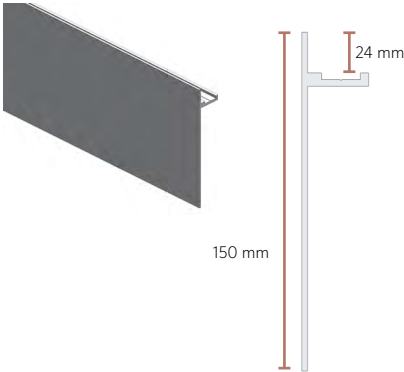
VISUAL	REFERENCE	DESCRIPTION	DECKING BOARD COMPATIBILITY
	1206	Powder coated aluminium skirting band Height: 100 mm for decking boards 20-23 mm thick. Length: 3750 mm. Set of 2	MOSO X-treme - 21 mm Kebony - 22 mm Accoya - 21 mm Thermo Ash - 21 mm Ceramic tiles - 18-20 mm
	2704	Raw aluminium skirting band Height: 100 mm for decking boards 20-23 mm thick. Length 3750 mm. Set of 2	
	1205	Powder coated aluminium skirting band Height: 150 mm for decking boards 20-23 mm thick. Length: 3750 mm. Set of 2	
	2705	Raw aluminium skirting band Height: 150 mm for decking boards 20-23 mm thick. Length 3750 mm. Set of 2	
	2637	Powder coated aluminium skirting band Height: 150 mm for decking boards 24-28 mm thick. Length: 3750 mm. Set of 2	Thermo pine - 26 mm DEX - 28 mm Nekko - 24 mm

ALUMINIUM SKIRTING BANDS WITH WOODEN DECKING BOARDS

Aluminium skirting band ref. 1206 or 2704

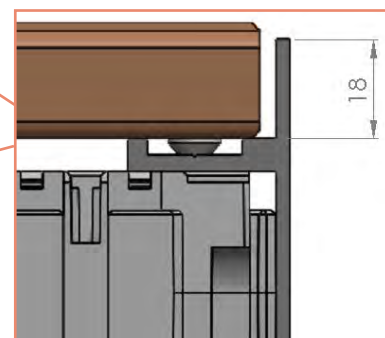
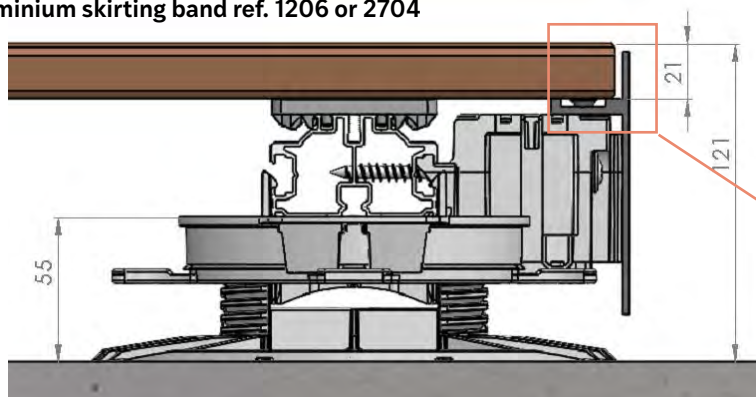

Aluminium skirting band ref. 1205 or 2705

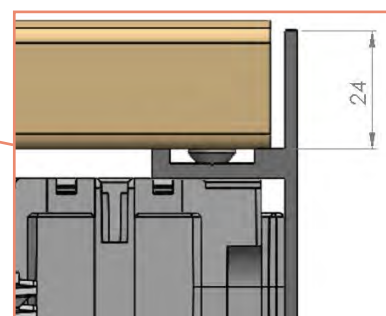
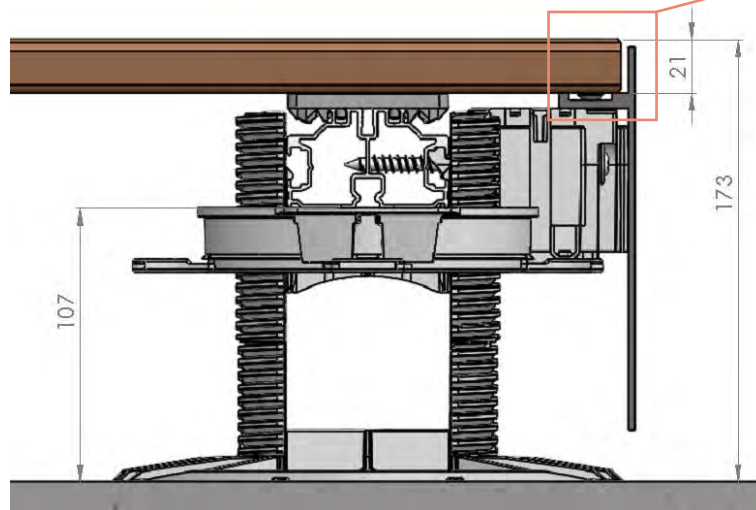

Aluminium skirting band ref. 2637

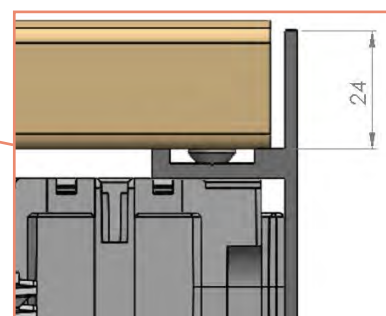
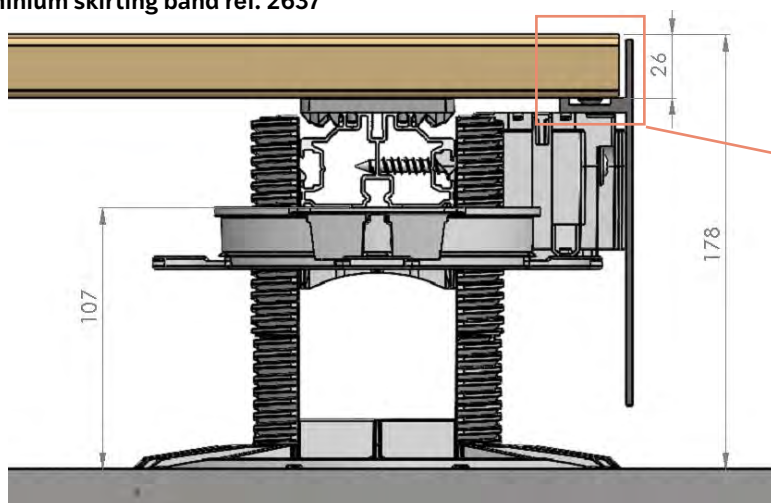

FASTENING THE SKIRTING BAND TO THE ALUMINIUM GRAD RAIL

To avoid a collision between the clip and the aluminium skirting band, the clip at the end of the rail must be removed and replaced with a half clip.

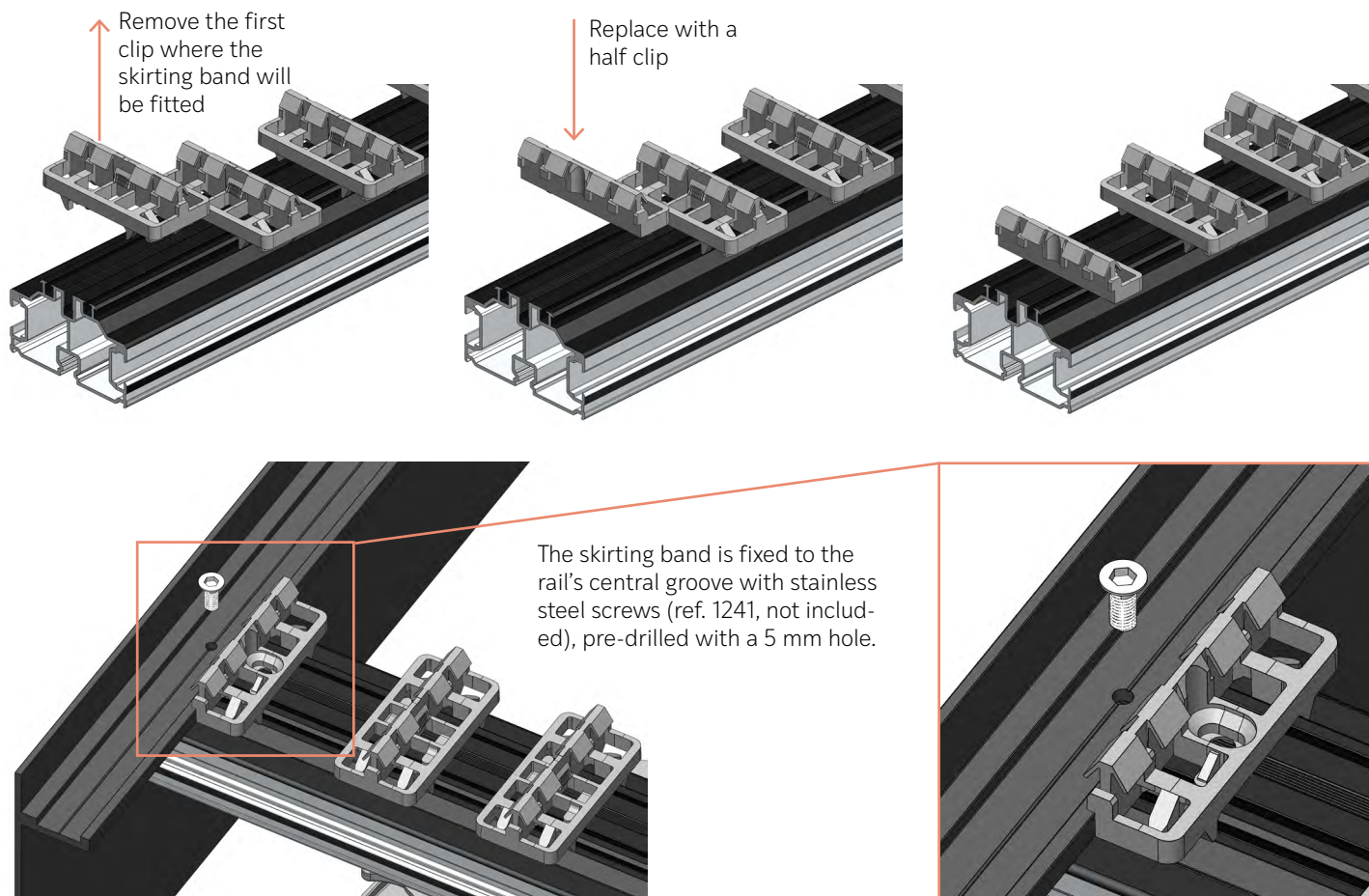

JOINING TWO SKIRTING BANDS OVER THE GRAD RAIL

Two skirting bands must be joined to the Top Cube or a Grad rail. There are slots for screwing the skirting bands to the Grad rail: 2 grooves on either side of the central groove.

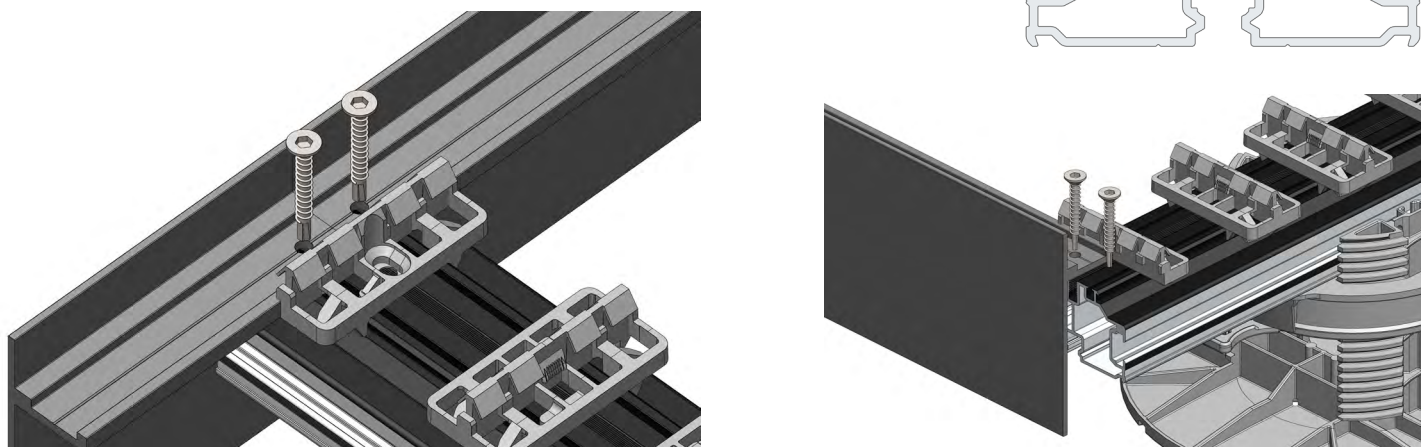

FASTENING THE ALUMINIUM SKIRTING BAND TO TOP CUBE

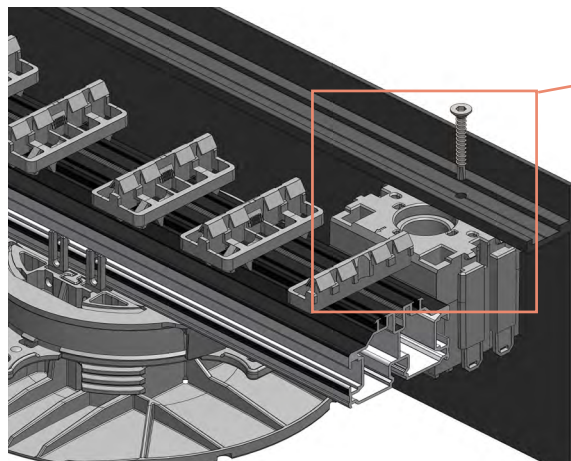

The skirting band is fixed to the Top Cube with stainless steel 4.8x38mm screws (ref. 1518, not included), pre-drilled with a 5mm hole.

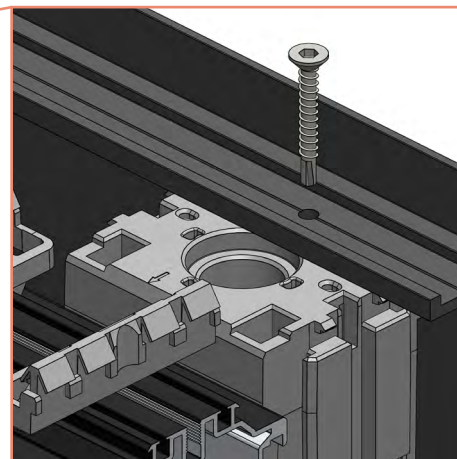

JOINING TWO SKIRTING BANDS OVER A TOP CUBE

Two skirting bands must be joined to the Top Cube or a Grad rail.
There are slots in the Top Cube for this purpose.

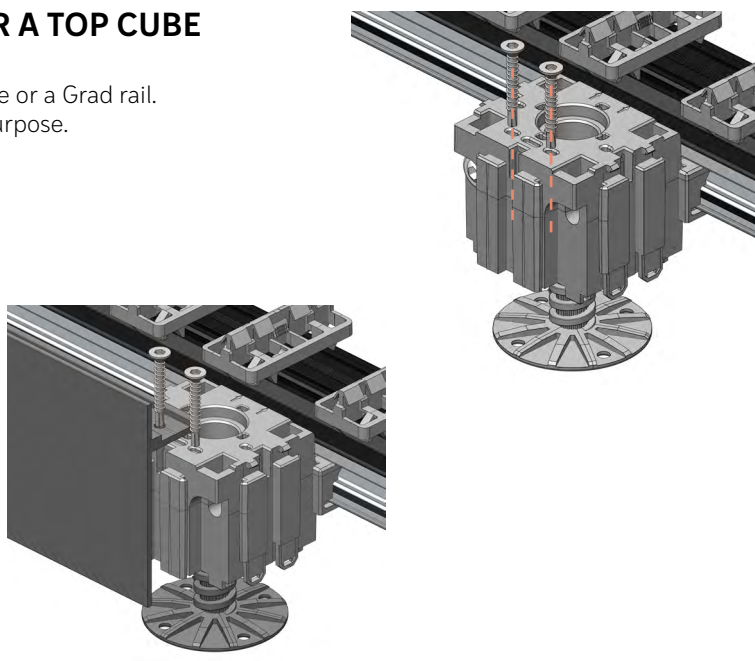
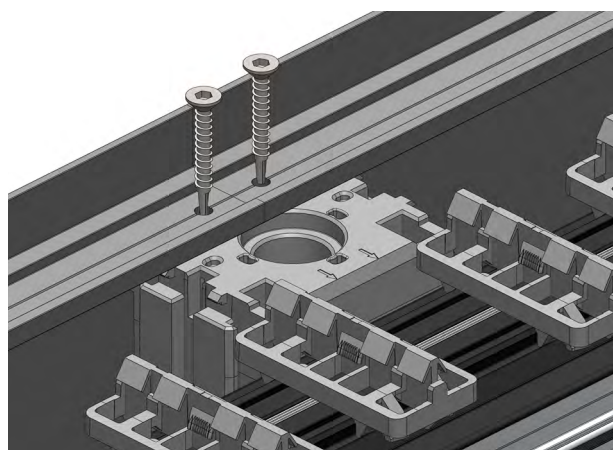

AIR CIRCULATION UNDER THE DECK

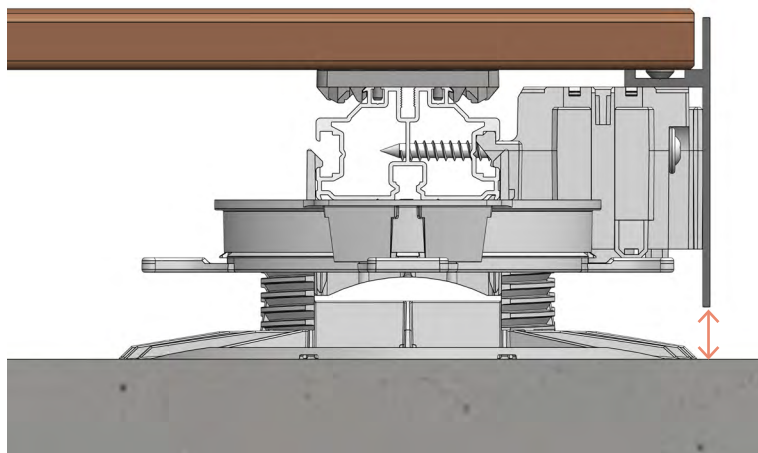

To ensure proper air circulation under the deck, a gap of at least 20 mm may be required, depending on the project or the constraints of the wood used for the decking boards. Please refer to the decking board supplier's installation recommendations and requirements (for ventilation, landscaping, etc.).

ALUMINIUM SKIRTING BAND WITH STONEWARE SLABS OR CERAMIC TILES

Aluminium skirting band ref. 1206 or 2704

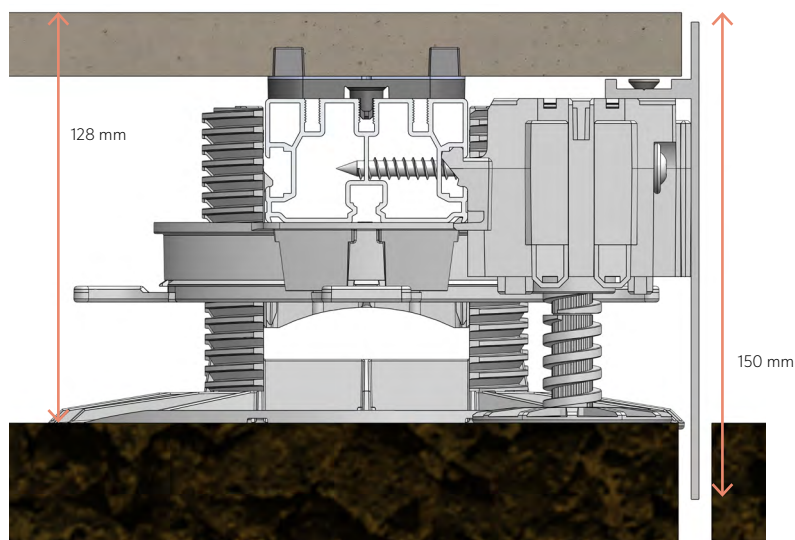
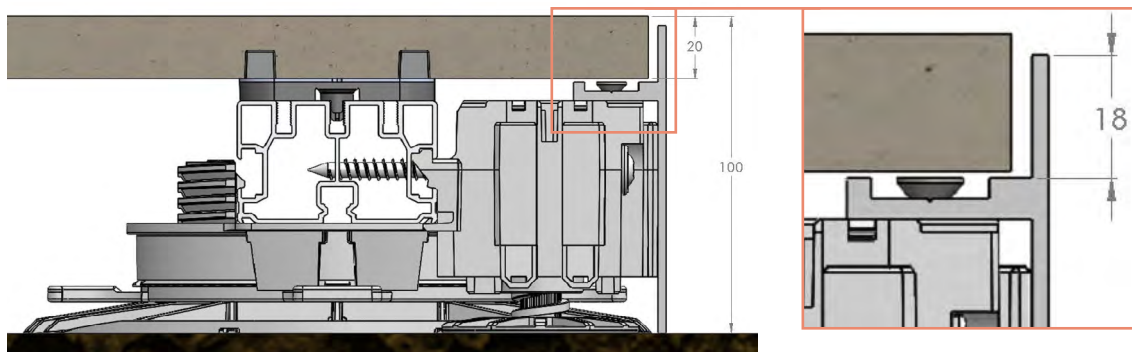
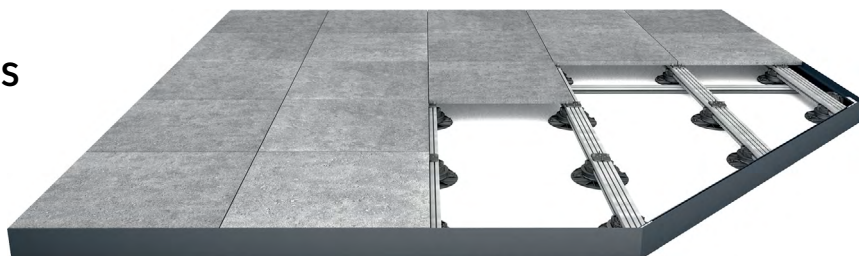

BURYING SKIRTING BANDS IN THE GROUND

For decks and patios on stabilized ground, it is possible to partially bury the aluminium skirting to adapt to the height of the ground.

